

## CAUTIONS

- 1) DO NOT PULL ON OR CARRY TORQUE SENSOR BY CABLE.
- 2) ANY TAMPERING OR REMOVAL OF COVER, CABLE, CONNECTOR AND/ OR OVERLOAD STOP WILL VOID WARRANTY.
- 3) ALWAYS HAVE SENSOR PLUGGED IN DURING USE TO MONITOR OUTPUT TO AVOID PERMANENT ZERO SHIFT AND OVER LOAD.

## IN USE

FUTEK OPTIONAL CHUCK ASSEMBLY	
ACCESSORY NO.	
F1416	1/16 to 3/8" Dia. BIT
F2995	5/64 to 1/2" Dia. BIT

### SCREW DRIVER ASSEMBLY

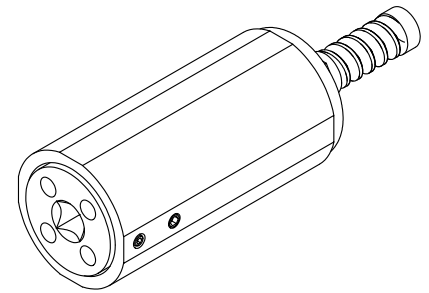
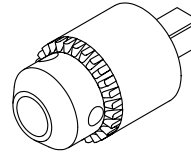

1

- DO NOT USE WRENCH OR OTHER DEVICES TO BOOST LEVERAGE.

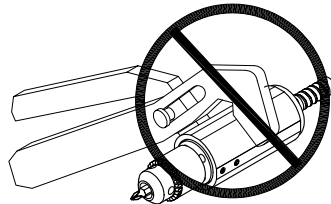

2

- SCREW DRIVER IS FOR TORQUE PURPOSES ONLY. DO NOT USE AS A CHISEL, PRY BAR SCRAPER OR ANY OTHER USES THAT IT IS NOT DESIGNED FOR

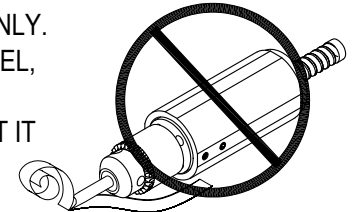

3

- TORQUE SHOULD BE IN LINE

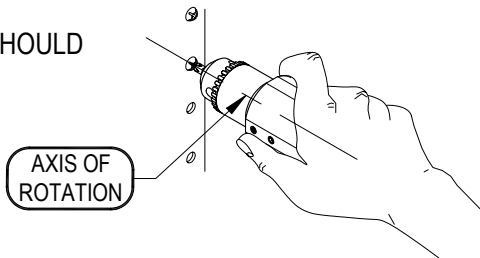

5

- A** HOLD SCREWDRIVER AND ROTATE HEAD UNTIL TEETH OPEN

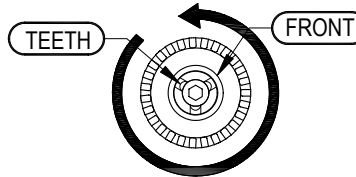

- B** INSERT DESIRED BIT

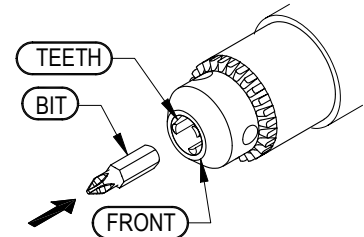

4

- TORQUE SCREWDRIVER IS USED ANYWHERE YOU NEED OR DESIRE PRECISION IN ASSEMBLY OR MAINTENANCE

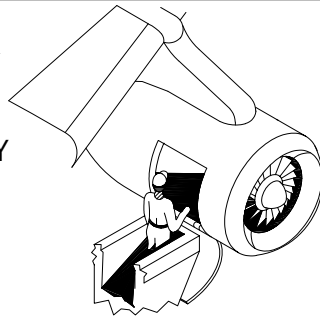

5

- C** HOLD SCREWDRIVER AND ROTATE HEAD UNTIL TEETH CLOSE ON BIT

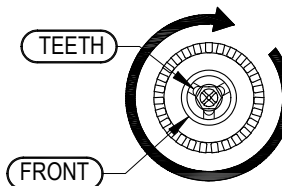

- D** HOLD SCREWDRIVER AND HAND TIGHTEN BIT WITH CHUCK KEY

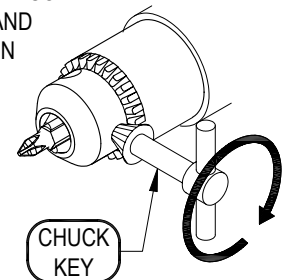

6

- TORQUE SCREWDRIVER COMES IN LOW CAPACITIES FOR PLASTIC OR LIGHT APPLICATIONS

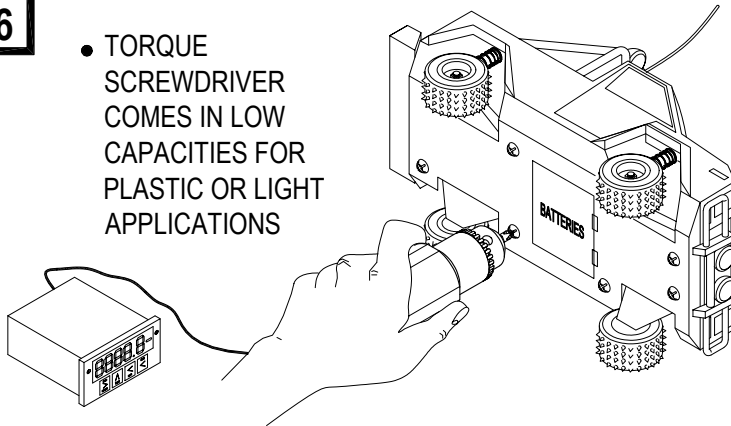

7

- TORQUE SCREWDRIVER STANDARD FEATURES

